

# Application Guide

PLANNING | WITH MONTAGE

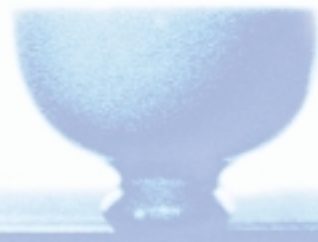

Steelcase



*What image do you want to portray?*

*Classy or casual? Forward or formal?*

*On the edge or in the mainstream?*

*The Montage® stackable frame-and-tile system gives you the aesthetic versatility to create any office environment, for any corporate style.*



---

*Consider Montage as a framework for your best ideas, and think of this planning guide as a resource of possibilities. The suggested configurations and planning tips will help you explore and create Montage environments with confidence.*

*For detailed ordering and specification information, refer to the Montage Specification Guide and consult your Steelcase dealer.*

## **CONTENTS**

The Possibilities	1
Thought Starters	7
Frames and Junctions	15
Off-Module Frames	17
Doors	18
Power and Voice/Data	19
Lay-In Cabling	21
Tiles	23
Worksurfaces	25
Lighting and Worktools	26
Storage	27



The possibilities are endless. Create any environment you can imagine with Montage.

**Engineering & Information Technology (p. 4)**

Montage offers a myriad of ways to support the work people do through collaboration, concentration and informal interaction.

The environment shown here is based on recent Steelcase research aimed at understanding how people use physical space to communicate, innovate, work and learn. Our studies revealed that companies that want to improve work process need to find ways to:

- Give people more control over privacy, technology and the work environment
- Support collaboration, concentration, and deep thinking
- Support multi-tasking
- Promote diverse collaboration
- Accommodate visitors and transient workers

These issues are addressed in this floorplan. Together, this collection of spaces can make it easier for people to understand their tasks, combine their knowledge, support established procedures, and share their completed work.

The following pages tell the rest of the story by focusing on four settings:

- Sales and Marketing
- Engineering and Information Technology
- Finance and Legal
- Cross-functional Teaming

Floorplans and isometric drawings illustrate how Montage can be combined with architecture and technology to address needs and enhance the work process. These are followed by a series of Montage thought starters (pages 7-14) that offer new ideas in supporting the work people do.

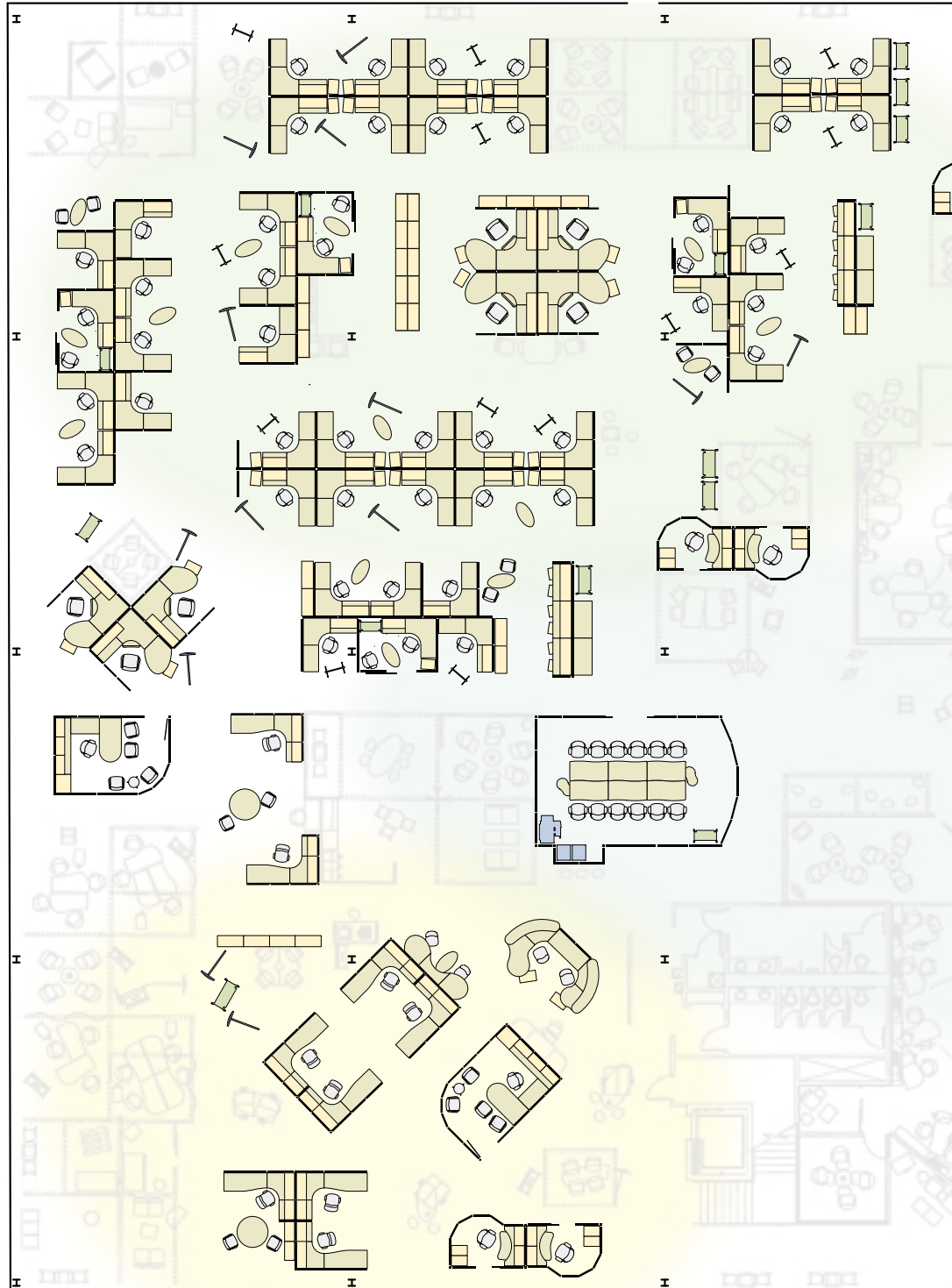

**Finance & Legal (p. 5)**



Sales & Marketing (p. 3)

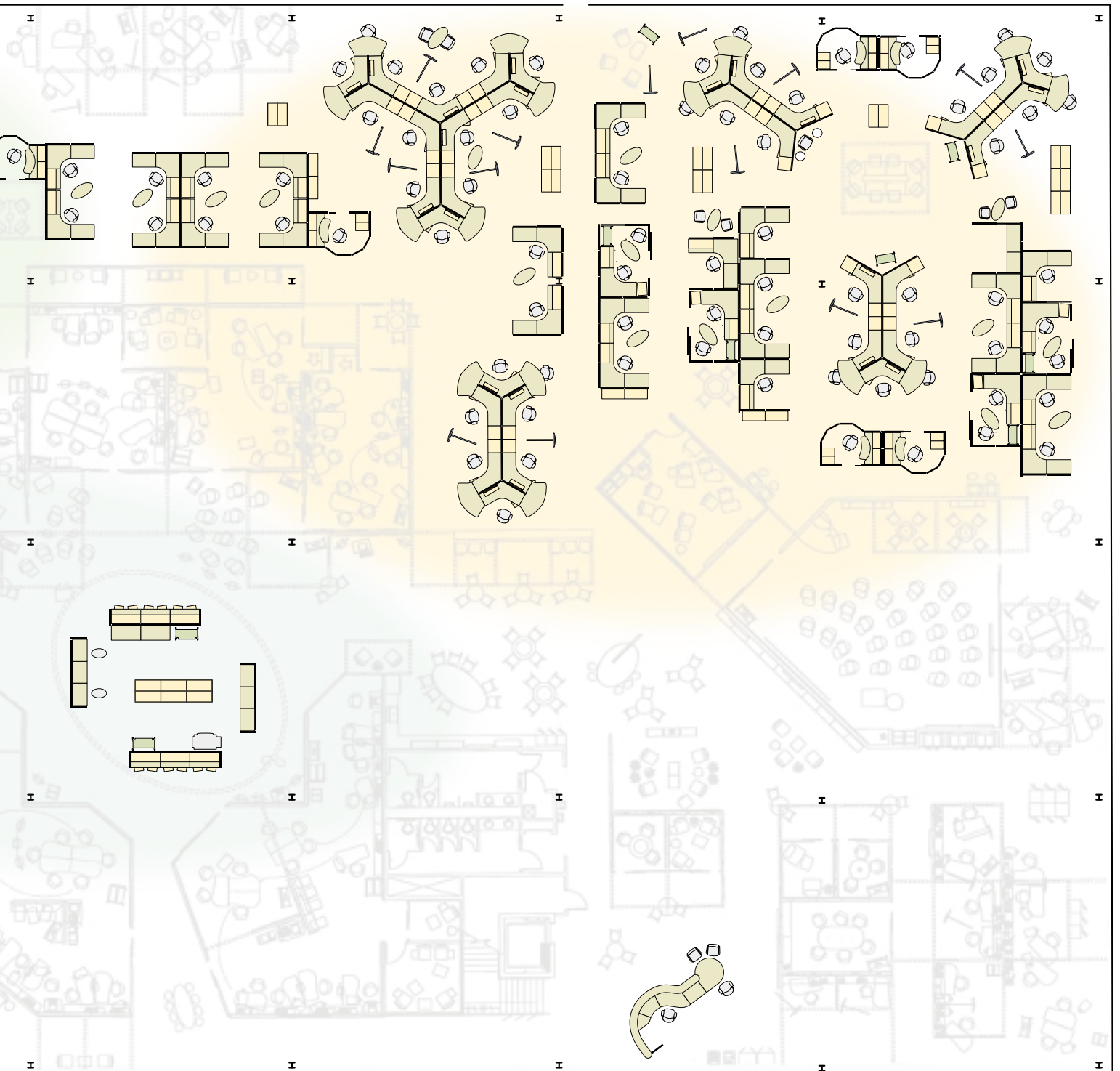

Cross-Functional Teaming (p. 6)

Reception Station (p. 9)



### Sales & Marketing

#### Needs

Support collaboration, concentration and flow

Allow for spontaneous conversation and group interaction

Provide an environment that enables people to relax and be inspired

Support organizational culture

Support work on the go

#### Montage Solutions\*

120°

Montage Harbor

Off-Module

\*Montage solutions identify the Thought Starter settings shown on pages 7-14.

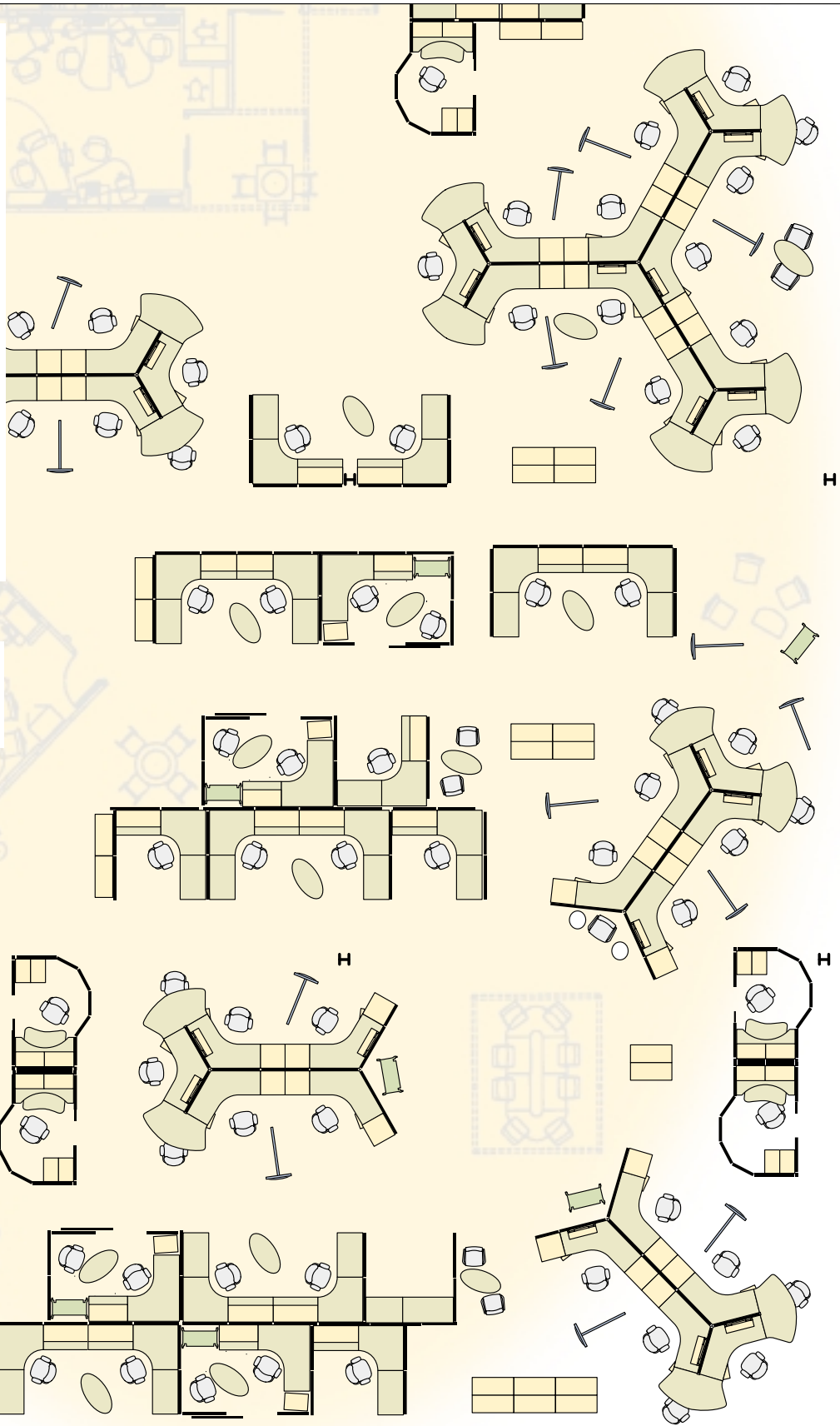

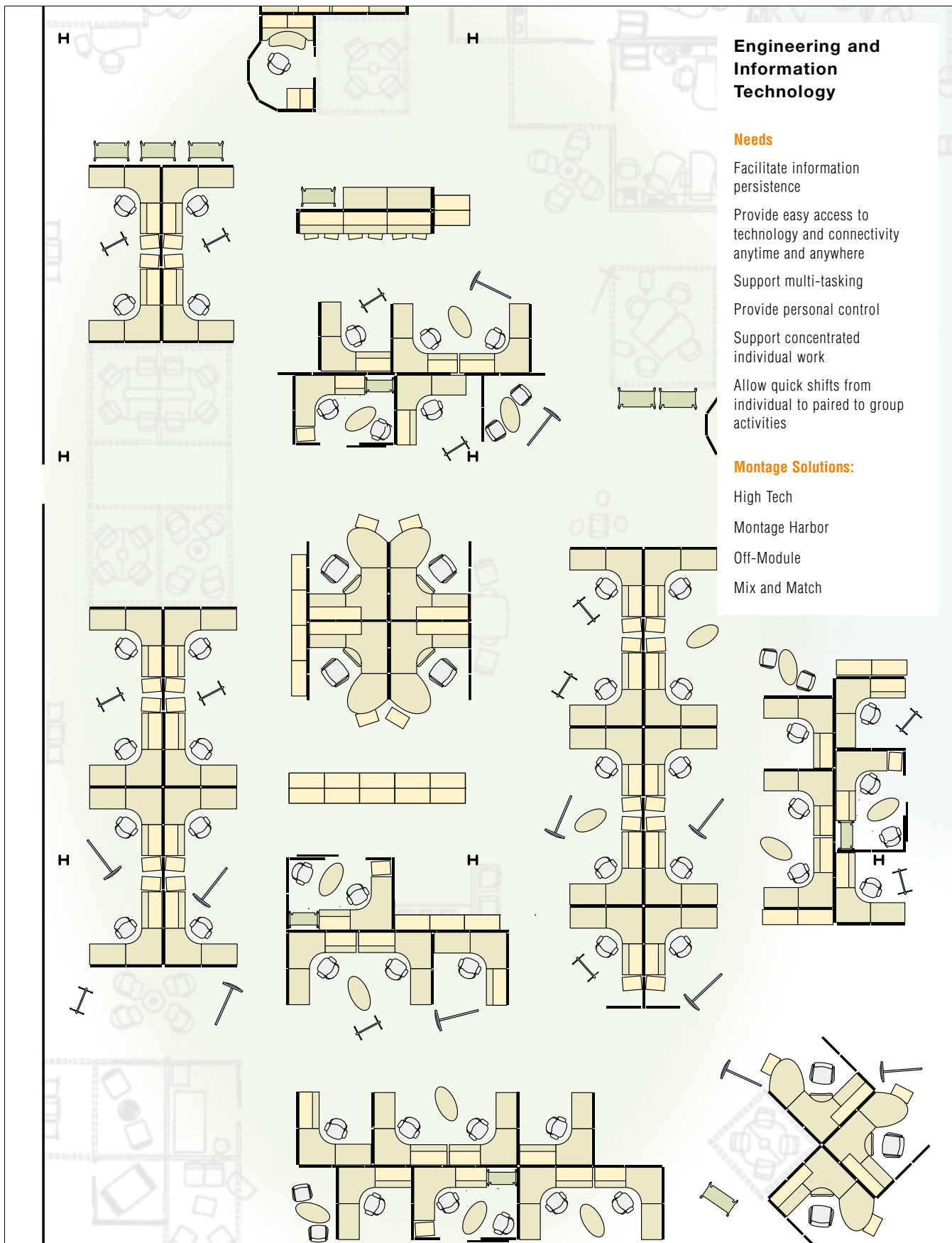

**Engineering and Information Technology**

**Needs**

- Facilitate information persistence
- Provide easy access to technology and connectivity anytime and anywhere
- Support multi-tasking
- Provide personal control
- Support concentrated individual work
- Allow quick shifts from individual to paired to group activities

**Montage Solutions:**

- High Tech
- Montage Harbor
- Off-Module
- Mix and Match

**Finance and Legal**

**Needs**

- Support concentrated work
- Support organizational culture
- Permit privacy on demand

**Montage Solutions**

- Montage Harbor
- Private Office
- Versatile
- Wood Selections





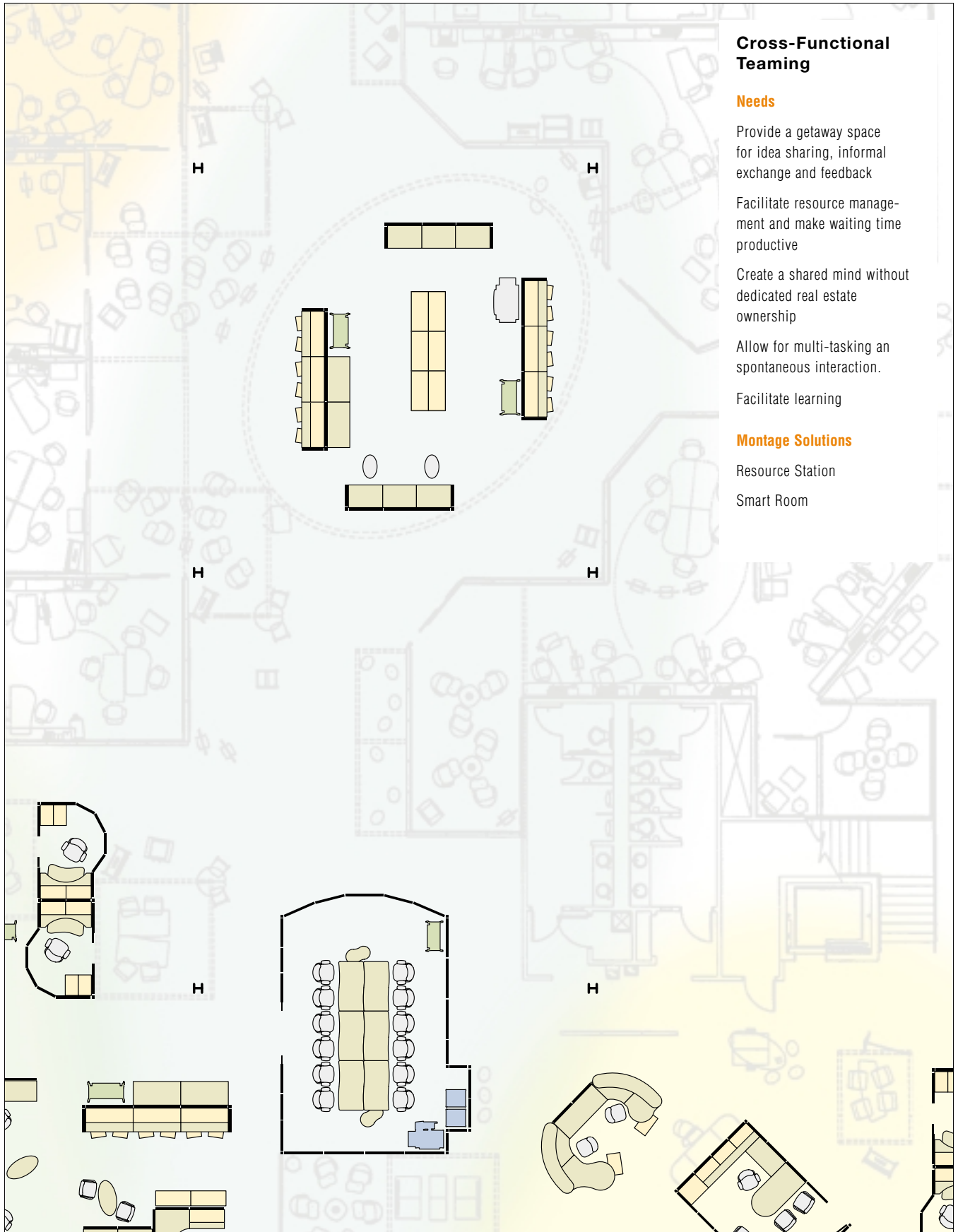

## Cross-Functional Teaming

### Needs

Provide a getaway space for idea sharing, informal exchange and feedback

Facilitate resource management and make waiting time productive

Create a shared mind without dedicated real estate ownership

Allow for multi-tasking and spontaneous interaction.

Facilitate learning

### Montage Solutions

Resource Station

Smart Room

*High design, high tech and high flexibility. Montage gives you any space in any style — open plans, private offices, meeting rooms, reception stations... whatever you need to create. Plus, extras like stackability, off-modular connections and lay-in cabling provide even more versatility.*

### Off-Module

By planning with off-module connections, you'll get ultimate flexibility and eliminate the need to order new parts when reconfiguring. Frames, worksurfaces, and storage can all be placed off-module. The lay-in cable track simplifies cable management. Each is demonstrated here. Also shown are Answer® worksurfaces and Details™ Worktools.

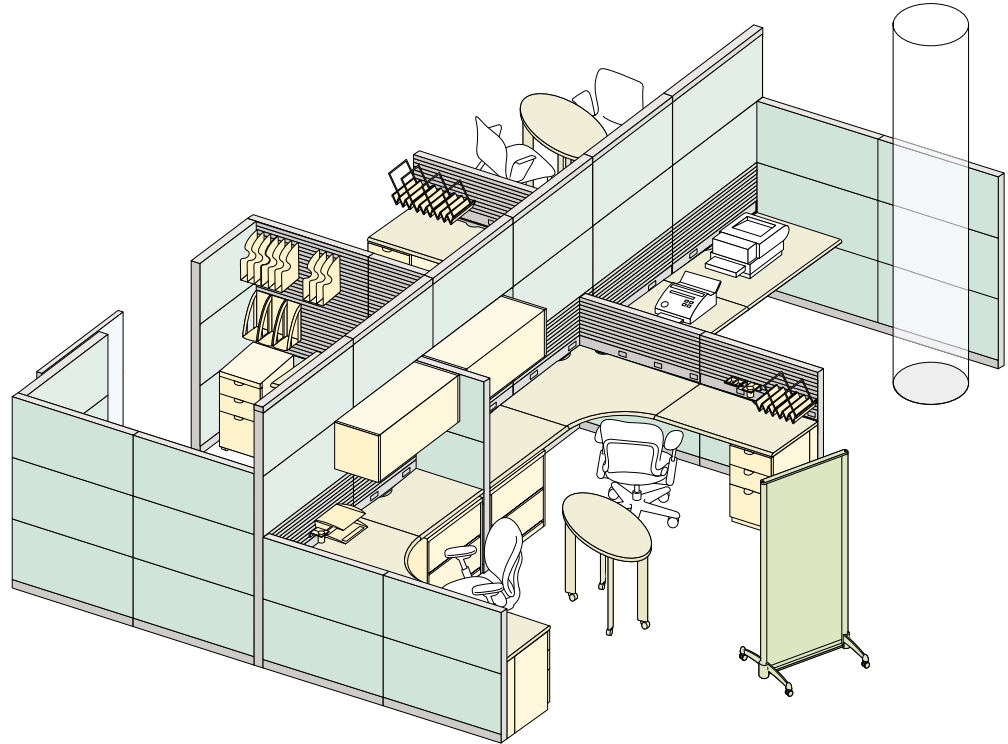

### Benefits of Off-Modularity

Easy to configure workstations around vertical columns or walls

Simple to create space for shared equipment and tools

Fin frames and storage (upper and lower) can be connected anywhere along a spine frame in 1.5" increments

Worksurfaces can be mounted anywhere along the frame

Saves floor area by reducing junctions and the dimensional creep they can cause

Flexibility for changes without ordering new parts

#### TIP

Frames can be connected off-module at any height.

Pedestals and end panels are available in both on- and off-module versions.

See the Montage Specification Guide for load and stability guidelines when placing components off-module.

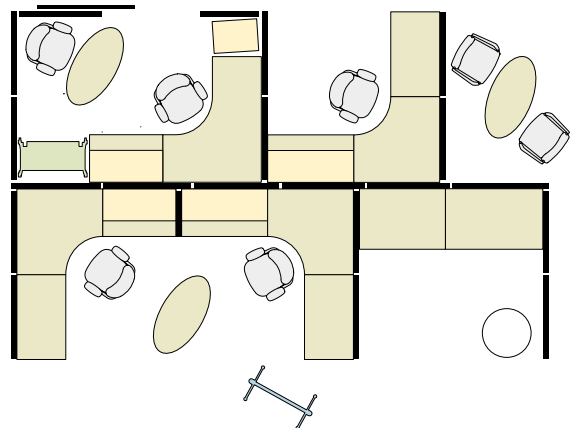

**120°**

Do you appreciate the benefits of 120° planning? Montage does, too. But it's also capable of much more — the same frames can be used for 120°, on- and off-module planning. With Montage, you're not stuck with one footprint. As for privacy, Montage can give you just the level you want by letting you add stackers and mobile screens from Metro® Detour.

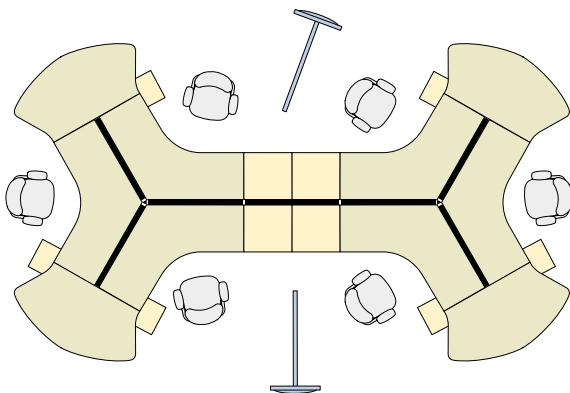
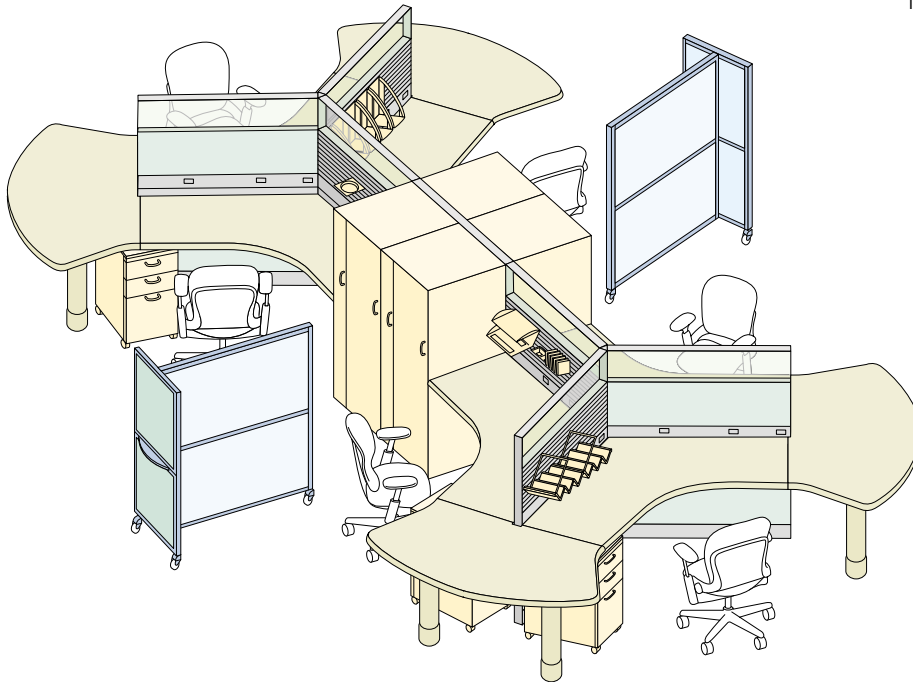

Specify frames with desk-height cavities if you want desk-height power access.

**TIP**



**Reception Station**

Make the right impression with a stunning reception station. Go contemporary with the patterned tiles and sterling frames shown here. Go classic with wood tiles and custom marble tops. Or go outside the norm with a look that defies definition. With 14 tile options at your disposal, you can establish just the right aesthetic to complement or contrast interior architecture.

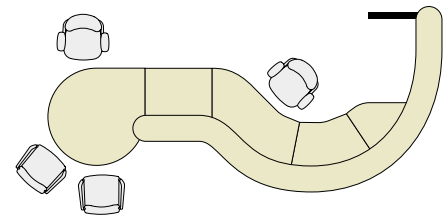
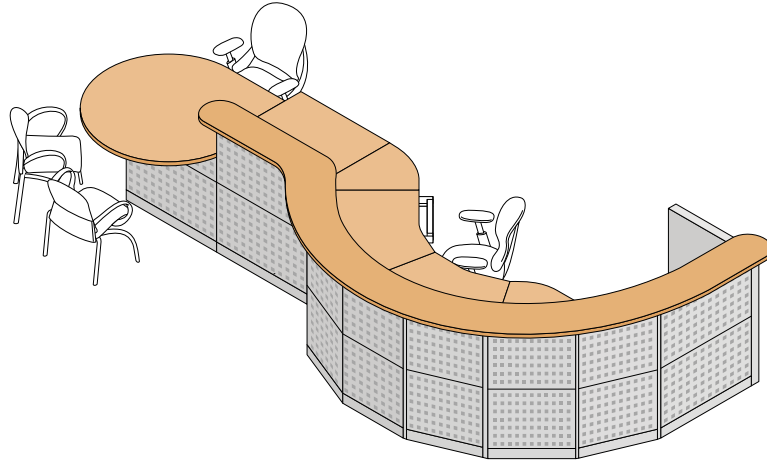

**TIP**

Tiles on opposite sides of a frame may be different materials and even different sizes.

**Wood Selections**

When only the rich warmth of wood will do, Montage Wood Selections deliver. Wood and rice-paper glass tiles help create a refined environment. A striking Pisa™ light from Details further illuminates this elegant space.

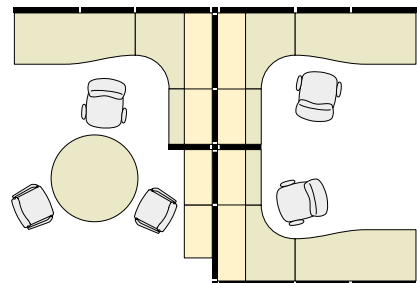
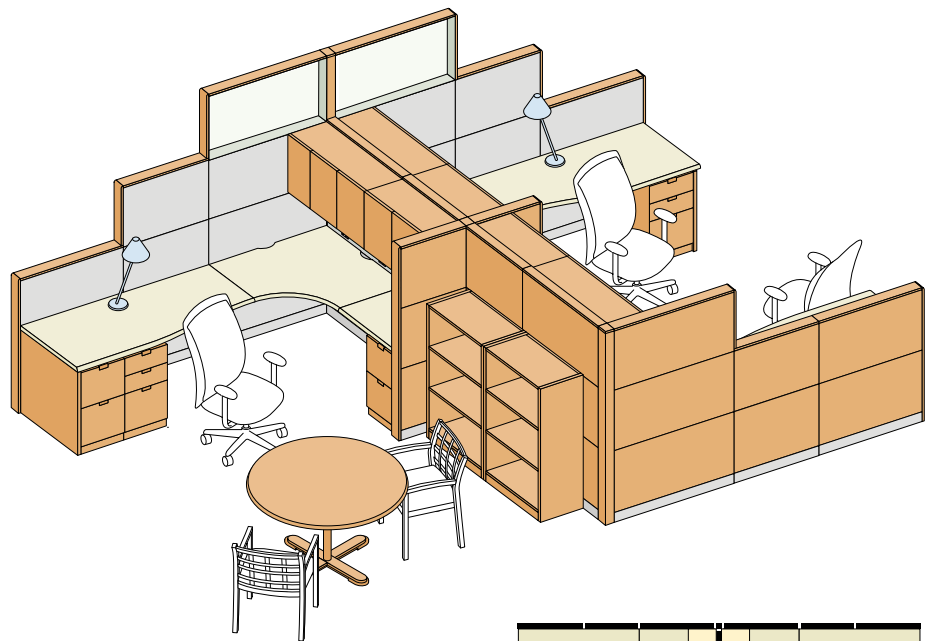

**TIP**

In change-of-height applications, be sure to specify the correct number and style of junction kits.

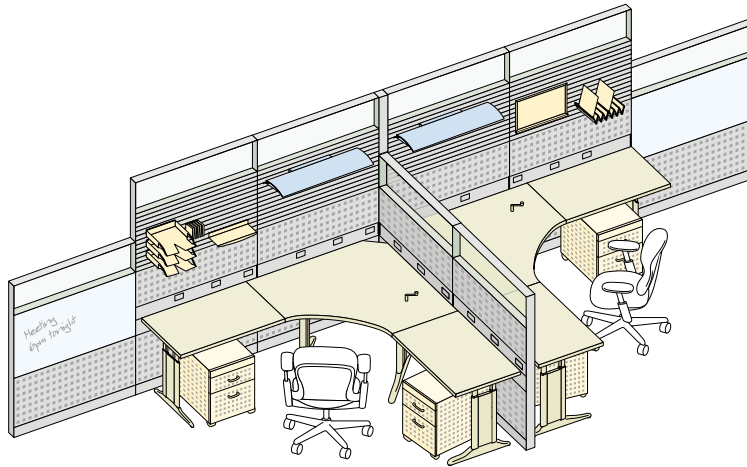

**High Tech**

Technology changes fast. With Montage, you'll have no problem keeping up. It's wired for work with virtually unlimited cable capacity, easy to manage lay-in cabling, Internode® compatibility, three power choices and versatile data access. Here, glass tiles soften the high-tech look, while slatwall tiles support Details Worktools and Canopy™ lights.

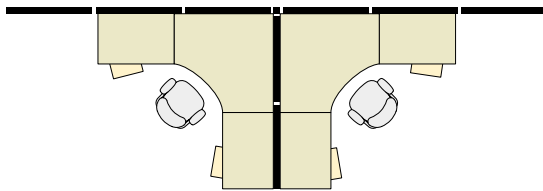

Specify 13" tiles in frame segments with desk-height power. The power system cavity cover takes up 7" of the 20" frame segment.

TIP

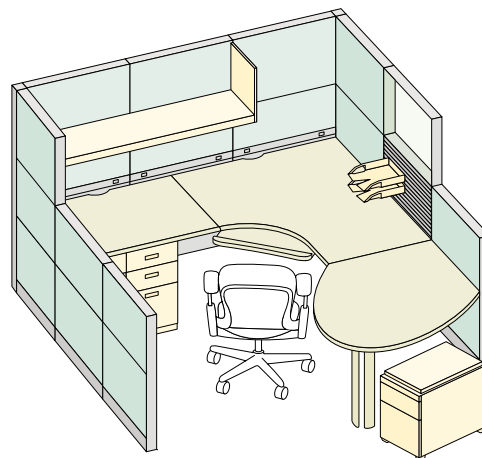

**Mix and Match**

For broader design options and greater value, consider blending Montage with other products. Answer worksurfaces can be panel hung, freestanding or a combination of the two. Answer pedestals and towers and Avenir® 200 Series pedestals provide a slightly different aesthetic, while helping you achieve a wide range of prices. Other economical strategies: use shelves instead of bins and specify steel tiles in spots that aren't readily visible.

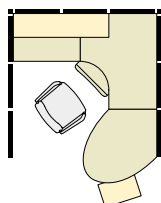

Due to slight size variations, Answer end-of-run worksurfaces wrapped by panels may need to be pulled in by worksurface brackets or trimmed slightly in the field.

When specifying Answer work-surfaces, you must use Montage worksurface supports. Exception: For some end-panel applications, use the Answer end panel with a Montage end panel bracket.

Answer C-legs can be used with Montage worksurfaces when the worksurface overhangs a cantilever by more than 6".

Specify base covers, desk-height cavity covers and end-of-run trim pieces separately.

TIP

**Private Office**

Fine-tune the privacy and functionality required of any work space with Montage tiles. Here, glass and wood tiles look great while effectively blocking sound. Inside, tackable and markerboard tiles are ready to go to work at a moment's notice, while slatwall-supported Details Worktools keep active storage handy. For an unmistakable aura of elegance, consider Wood Selections panel-hung and freestanding casegoods.

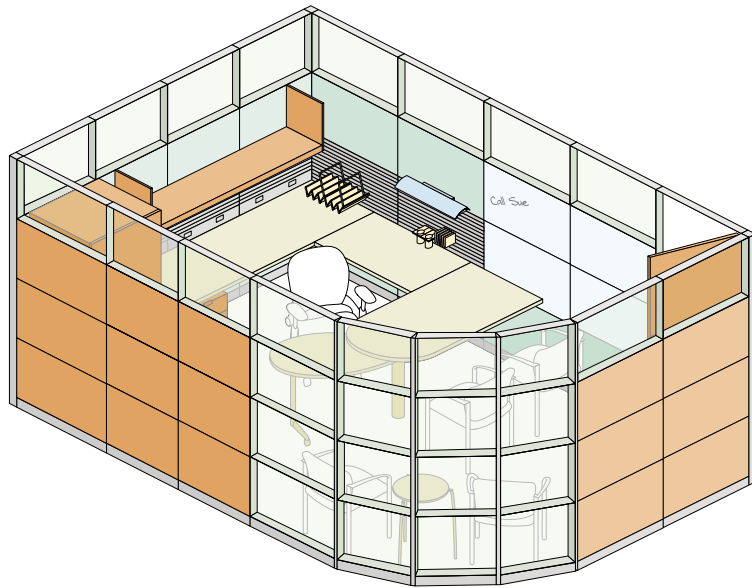

**TIP**

For optimum acoustical performance, use hard tiles (i.e., glass, wood, steel, slatwall.) Use HPA tiles where tackability is required, but never back-to-back.

When using a door in an 86" high application, be sure to order the stabilizer plate.

See Specials handbook for the 4-hinge frame needed to accommodate solid wood doors.

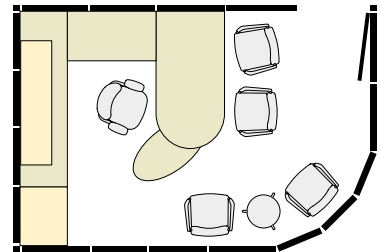

**Montage Harbor**

Concentration without isolation. Glass and solid tiles enclose a comfortable harbor with a pocket door that slides closed to provide instant privacy or open to welcome visitors. Desk-height power and data make it easy to get connected. The mobile worksurface increases flexibility, while the curved wall enhances the visual aesthetic.

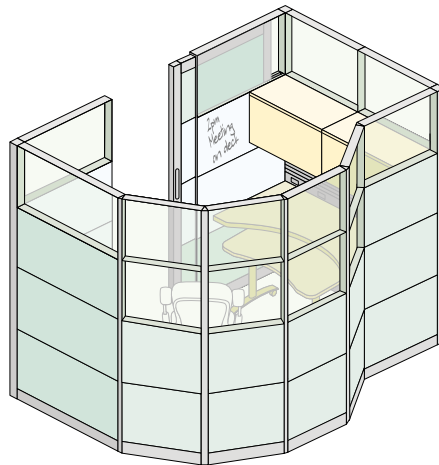

**TIP**

Pocket doors can double as presentation boards when you specify markerboard inserts.

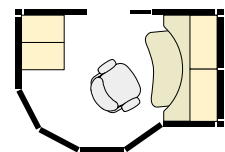



### Smart Room

Cable capacity and convenient power and data access enable this meeting room to accommodate any technical challenge. Note the combination of tiles: hard tiles to block sound, patterned glass to create semi-privacy, and clear glass to make the area seem more expansive. Meanwhile, double pocket doors eliminate distractions without taking up floor space. And the curved wall? It's made possible by custom angle junctions.

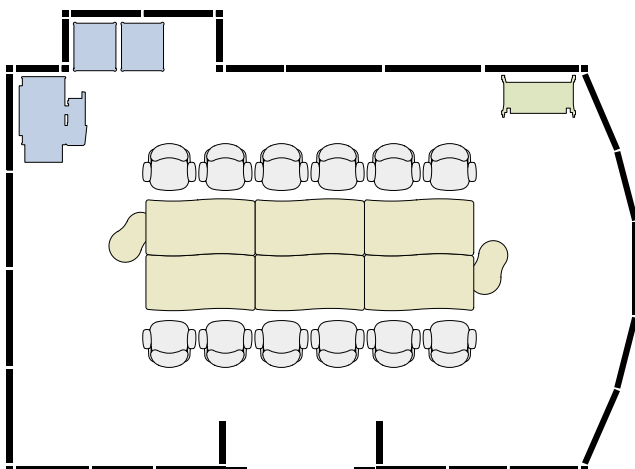
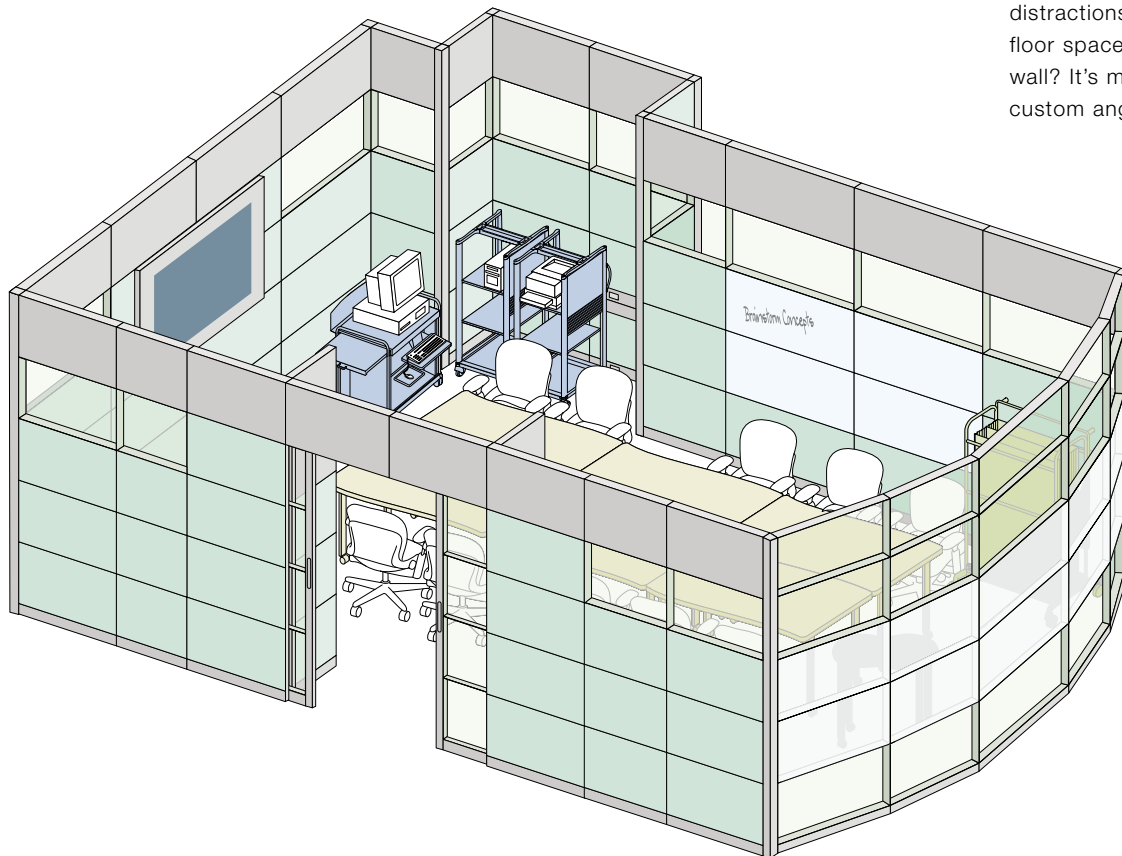

Check stability guidelines in specification guide for long panel runs.

Specifying glass tiles? Be sure to select either black or gray trim kit colors to match the frame color.

TIP

**Resource Station**

When a lot happens in a little space, Montage keeps everything running smoothly. Here in the resource station, you'll find multiple storage options, as well as desk-height power and data access. The tiles offer a bit of everything — slatwall, markerboard and tackable for efficiency; glass for aesthetics; laminate for durability; perforated, indented and domed for texture and durability; and painted steel for economy.

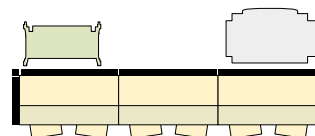
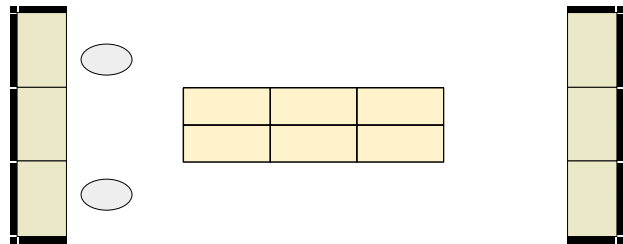
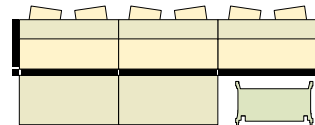
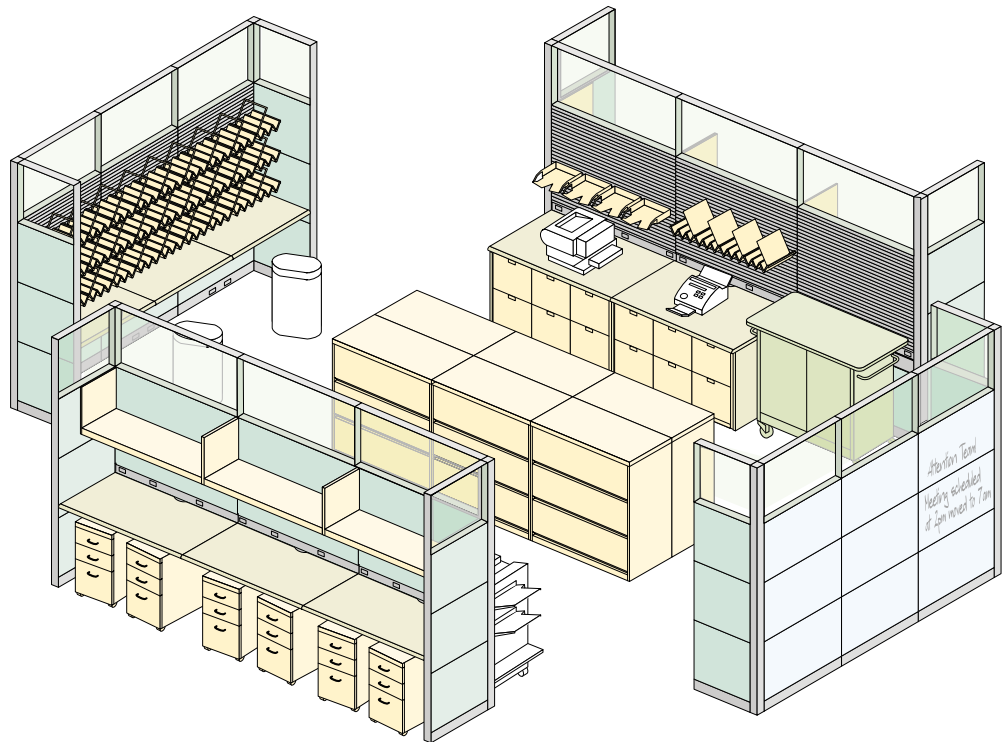

**TIP**

When configuring frames, be sure to follow the load, stability and length-of-run guidelines in the Montage Specification Guide.

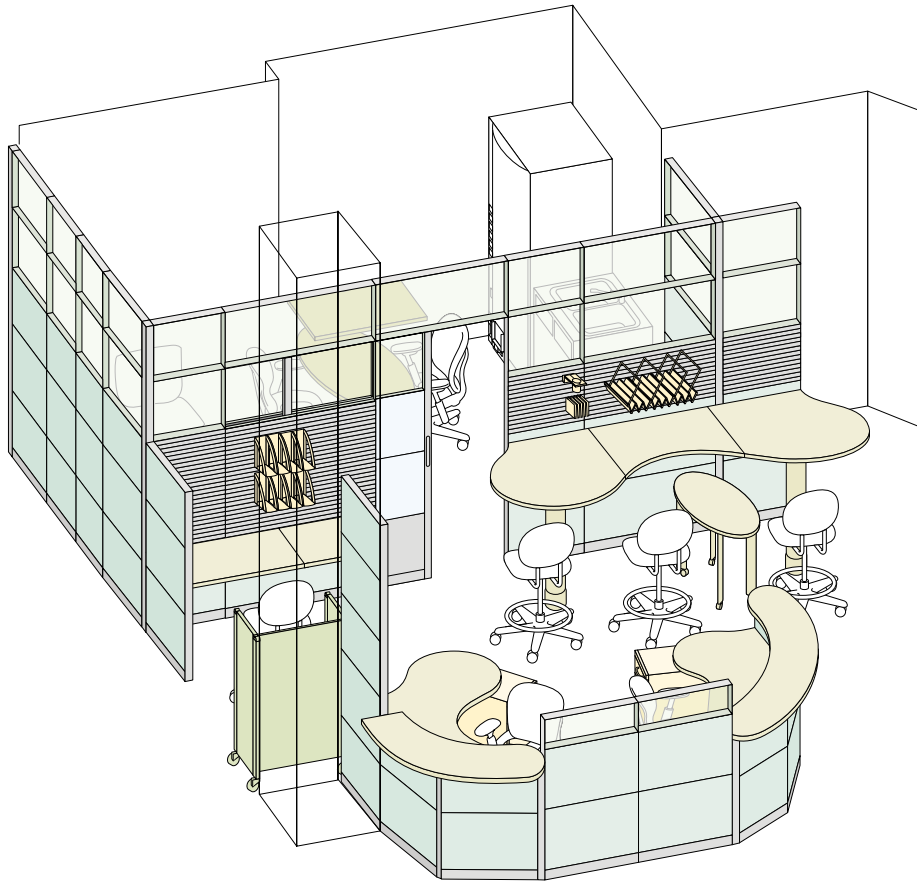

### Versatile

Adjacent spaces for collaboration and privacy mix easily in this installation, exemplifying the ability of Montage to support all work styles. Note how off-modularity and custom angle frame junctions permit an extra degree of planning freedom. Also evident is another Montage hallmark — endless tile options and configurations.

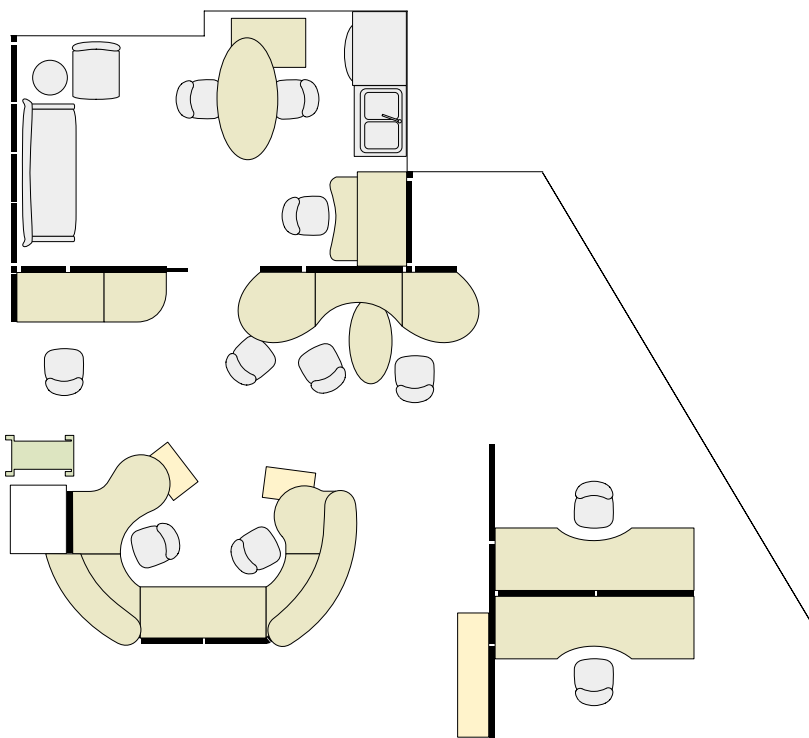
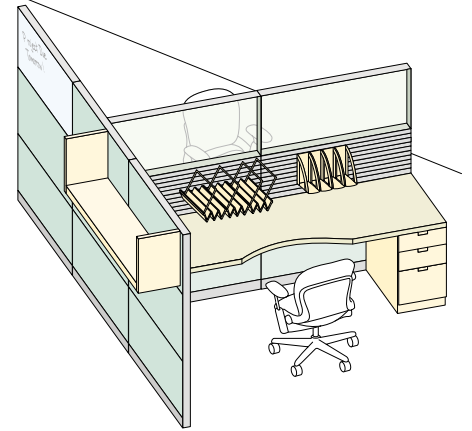

Unlike swing doors, pocket doors don't use up any floor space when open.

TIP



Whatever configuration you decide on, Montage frames can make it happen. Off-module capabilities and stackable frames give you all the flexibility you'll ever need.

**Standard [a]**

Use standard frames only when adding to existing installations. They're appropriate for on-module planning or as fin walls in off-module applications. Though standard frames accept either standard or enhanced tiles, they can be used only with standard stackers.

**Enhanced Standard [b]**

Use enhanced standard frames for new installations. Like standard frames, they're appropriate for on-module planning or as fin walls in off-module applications. Enhanced standard frames accept enhanced tiles and enhanced stackers only.

**Enhanced Off-Module [c]**

For off-module planning, use enhanced off-module frames. Slots every 1.5" (horizontally) permit maximum flexibility in connecting frames, worksurfaces and overhead storage off-module. Enhanced off-module frames accept enhanced tiles and enhanced stackers only.

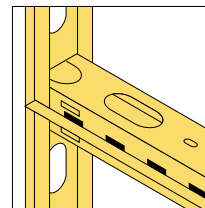
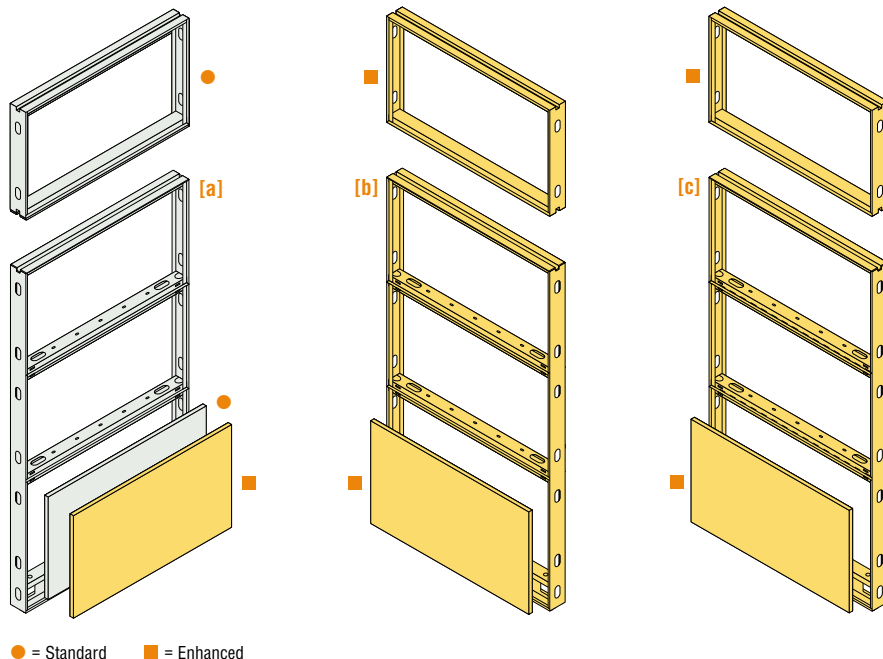

Off-module frame detail

**Frame Colors — Two Options**

Choose either traditional black frames or, as an upcharge option, select contemporary sterling mica.

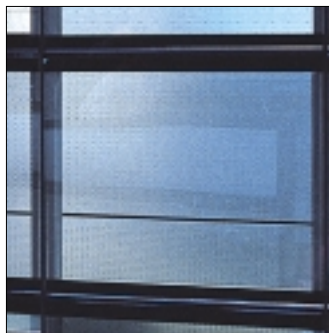

Black



Sterling Mica

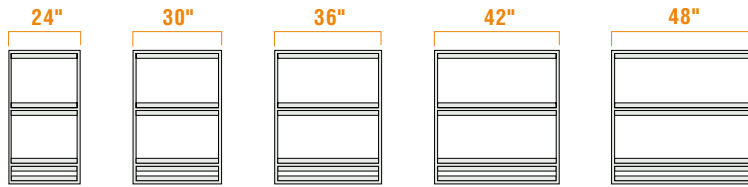

**Width and Height**

Montage frames are available in five widths (shown), each of which may be specified in any of three base frame heights — 45\", 65\" and 86\". A single exception is the 24\" x 86\" configuration, which is not available.

**Custom Heights**

Custom frame heights are also available, with the most common request being for a 38\" high frame for transaction tops and 55\" base frame for seated privacy.

**Stacking**

20\" stackers (of any width) may be added to base frames to expand functionality, create different looks and bring the total height up to 106\".

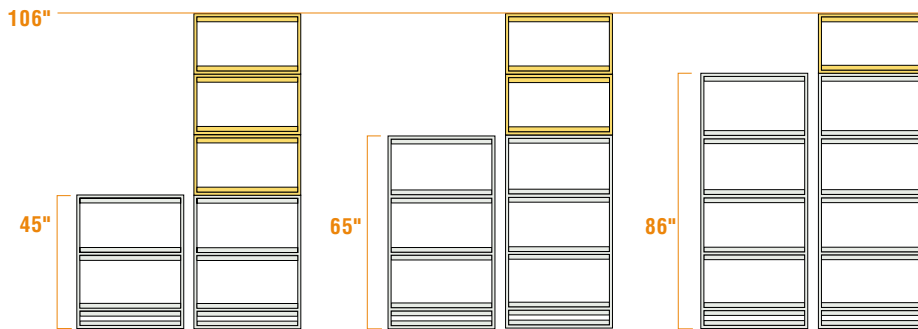

Use stackers only when you need the flexibility of variable heights. Otherwise, specify taller base frames, which provide greater structural strength and lower cost of ownership than a frame/stacker combination.

TIP

JUNCTIONS

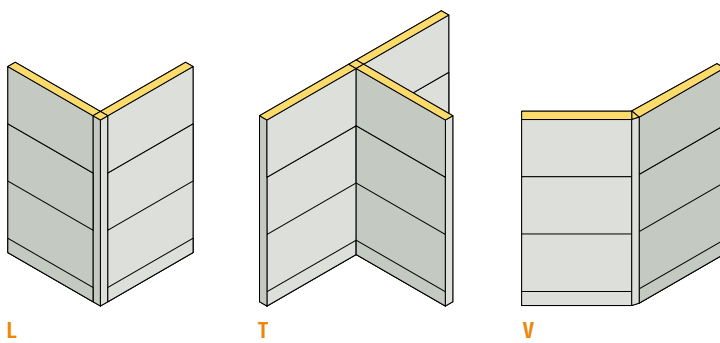

L

T

V

**Junction Kits**

For on-module planning, use junction kits to join adjacent frames of the same or different heights in L, T, V, Y and X configurations. Junction kits are available in square, chamfered and radius profiles. For off-module planning, junction kits aren't needed.

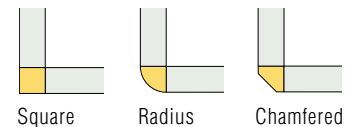

Square

Radius

Chamfered

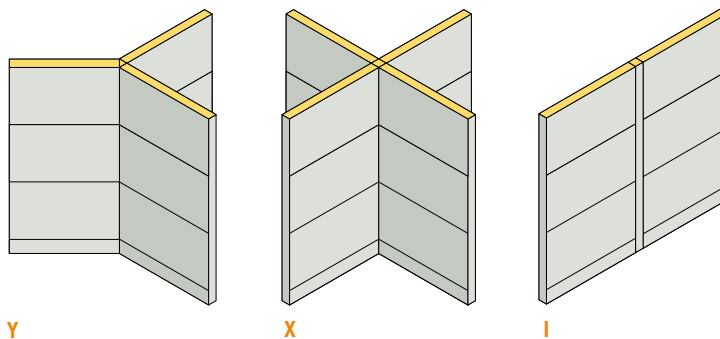

Y

X

I

**In-Line Junctions**

Junctions aren't necessary to join frames in a straight line (I configuration). Nevertheless, an in-line junction kit is available if you need to accommodate desk-height power or wish to add length to an in-line panel run (perhaps to maintain alignment with other panel runs).

**Custom Junctions**

Custom angle junctions are available for unique configurations.

*When pretty close isn't good enough, off-modularity is the answer. Enhanced off-module frames let you position fin walls, worksurfaces and storage right where they'll work best — without regard to the location of frame junctions or building architecture.*

**Choose Your Strategy**

Flexibility or economy? The availability of off-module frames means you can have either — or both.

**[a]** For the lowest price, use standard or enhanced standard frames exclusively.

**[b]** For the ultimate in flexibility, use off-module frames exclusively.

**[c]** For a custom mix of flexibility and economy, use a combination, placing off-module frames only where you need them (such as on a spine wall) and standard or enhanced standard frames everywhere else.

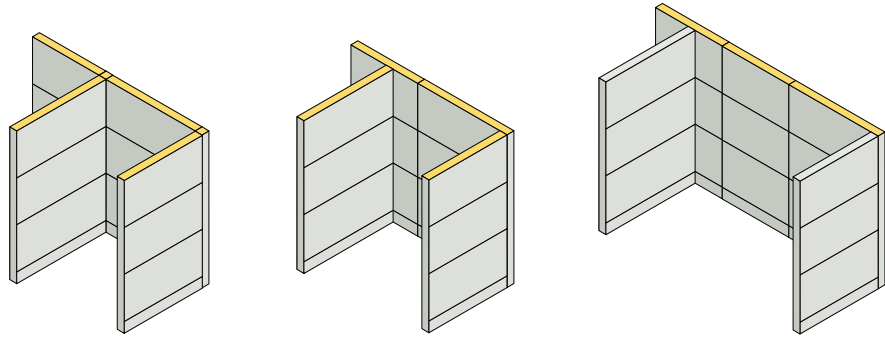

**[a]** All standard or enhanced standard on-module

**[b]** All off-module

**[c]** Off-module on spine only

**TIP** Off-modularity can be integrated into existing installations by incorporating new off-module frames as the spine and reusing standard frames as fin walls.

Use a mid-frame off-module frame bracket for in-line or mid-frame off-module connections.

Use an end-of-frame off-module bracket for 90° “L” type end-of-frame connections.

**Three ways to connect frames off-module**

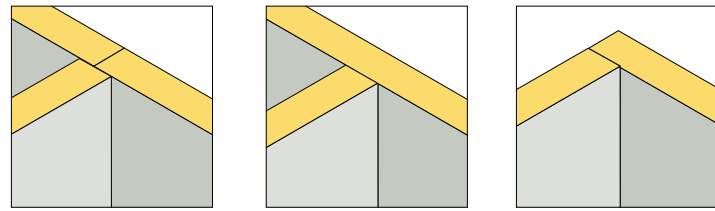

In-line

Mid-frame

End-of-frame

**Why Compromise?**

Off-modularity lets you place worksurfaces and storage components precisely where you want. Here, moving a storage bin frees up room for a large monitor.

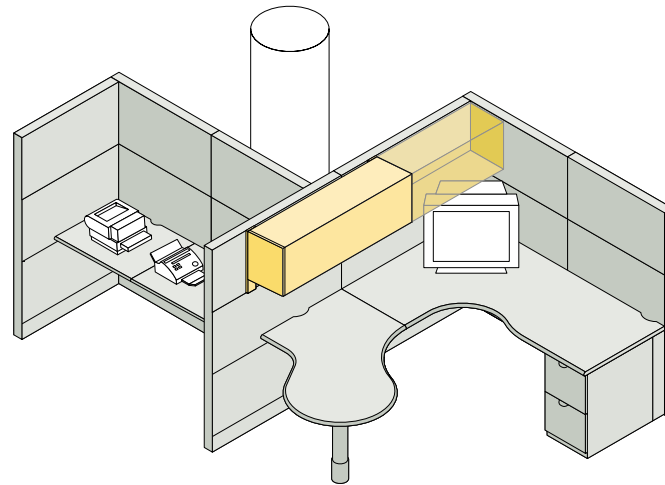

**TIP** Off-module connections do not attach to junction covers. You can, however, bridge over junctions with off-module overhead storage and worksurface connections.

If your installation includes private offices or meeting rooms, Montage offers a choice of two door styles, providing the privacy you need in whatever look you want.

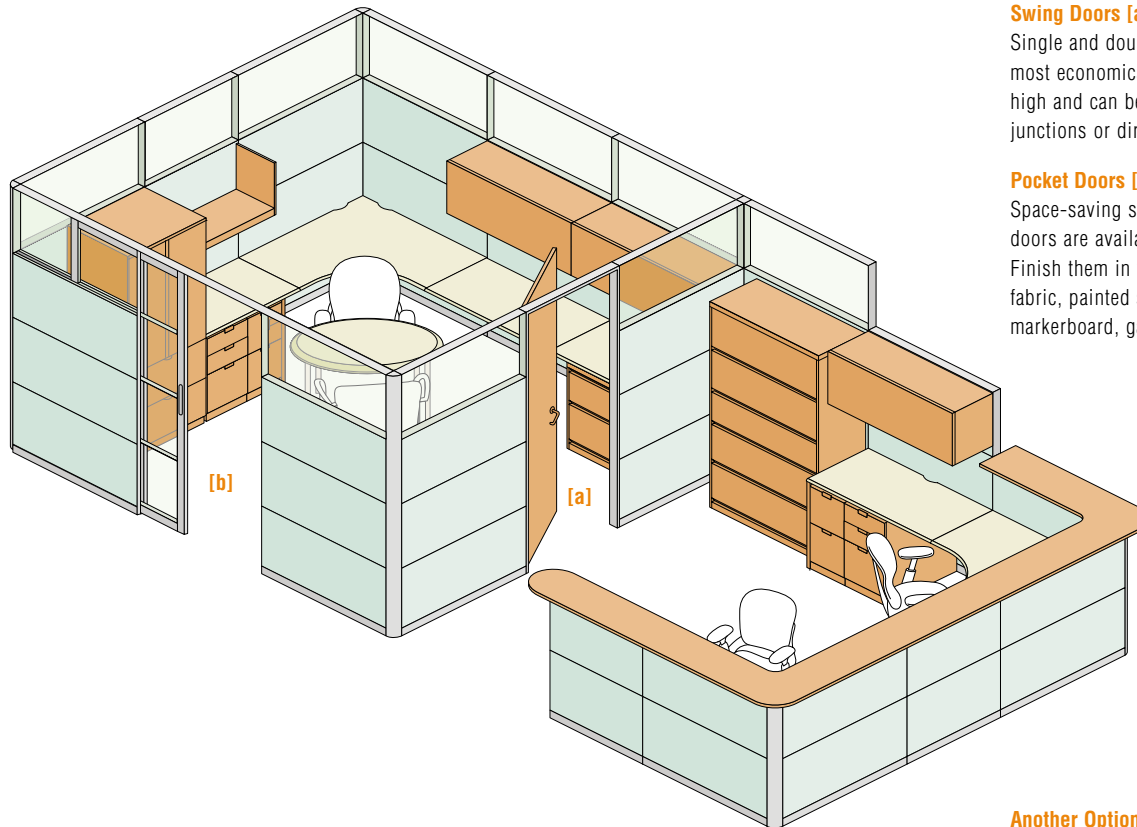

#### Swing Doors [a]

Single and double swing doors are the most economical choice. They are 86" high and can be attached to frames, junctions or directly to the wall.

#### Pocket Doors [b]

Space-saving single and double pocket doors are available in three widths. Finish them in your choice of tiles: fabric, painted steel, laminate, glass, markerboard, galvanized or wood.

#### Another Option...

##### Incognito Doors From Details

Incognito doors also complement Montage. See the Incognito Specification Supplement (D6703) for ordering information and contact Details Specials for aesthetic options that match Montage frames.



Pocket and swing door frames do not accommodate off-module connections.

TIP

Check local codes for compliance issues specific to your area.

*Talk about being empowered — Montage supports all the technology you'll ever need by making it uncommonly easy to route and access power and data.*

### Access to Power

Access power wherever you choose at floor or desk-height, on spine or fin walls... even off-module.

#### Powerkit

Powerkit has three options: One 3-circuit, 60-amp solution (separate neutral), or two 4-circuit, 80-amp solutions (3+1, 2+2). Connections simply snap together.

Powerkit can be specified with 15- or 20-amp receptacles and is compatible with Internode components.

#### Powerway

A 4-circuit, 80-amp solution (2+2), is available for existing installations that already use it. Powerway is not compatible with the Powerkit system.

#### Internode®

Internode components can be field installed to route power outside the frame and provide access above or below worksurfaces.

### Access to Voice/Data

Multiple options for voice/data terminations and cable management provide the ultimate in flexibility and convenience. Cable access is available at the base, below the worksurface, at the beltline, and any place on the tile.

#### Capacity

170 category 5 cables can be routed horizontally in each 20" frame segment, terminating at desk height, in the base, or anywhere in the tile. Optional lay-in cable tracks expand cable capacity even further.

#### Internode

Internode components can be field installed to route voice/data outside the frame and provide access above or below worksurfaces.



#### TIP

Power receptacles are specified separately.

Powerkit can be routed off-module at base or desk-height. See Montage Specification Guide for instructions and application restrictions.

Make sure and order exclusively Powerkit or Powerway components and covers as the Powerway and Powerkit systems do not work together.

For desk-height power access, each cluster of workstations must contain at least one junction to allow for a base-to-desk transfer cable, or a ceiling feed through a power pole.

Cables can be pulled down to the worksurface through the frame except where glass tiles are being used.

Cable routing capacity is limited behind perforated or HPTA tiles (high-performance tackable acoustical).

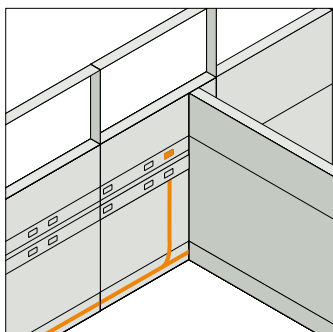

**Power**

[a]

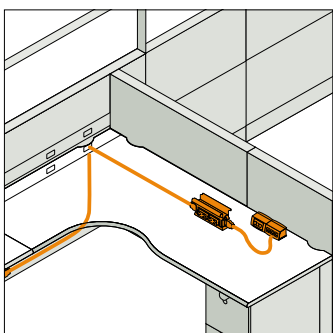

[b]

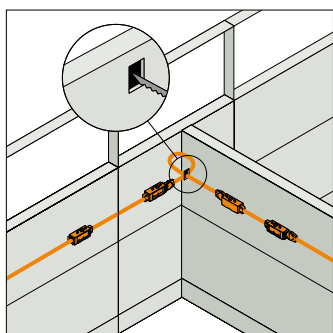

[c]

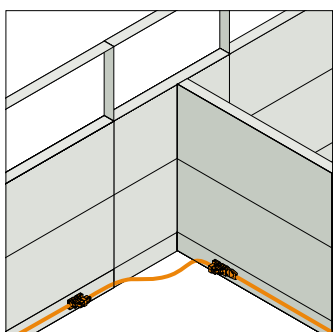

[d]

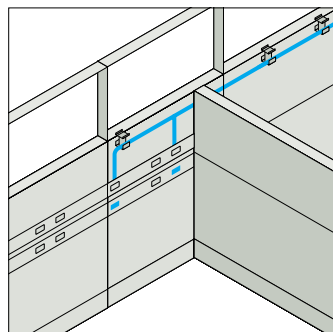
**Voice/Data**

[a]

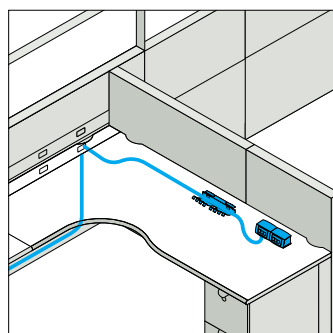

[b]

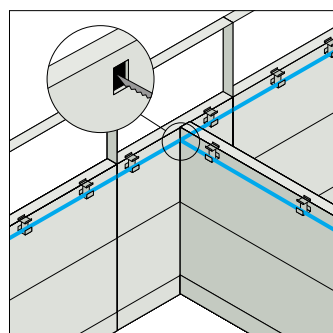

[c]

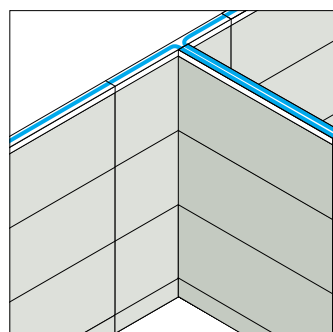

[d]

**Four Options for Planning Off-module Power and Voice/Data**

Montage can plan on-module in many configurations with power and data. When it comes to off-module planning, there are four ways to approach your power and voice/data needs.

**[a]** Place power or data in the spine only. This is the most economical strategy because it lets you move fins without rerouting electrical or voice/data components.

**[b]** Plug an Internode harness into a receptacle at the base of the spine, then route it under the fin work surface. This solution provides access above or below the fin work surface without using the fin panel for routing.

**[c]** Transfer power or voice/data internally from the spine to the fin. For power, this requires an extra harness as well as field cutting the 13" tile above the desk-height cavity. For voice/data, the harness is not used, but the field cut is still necessary.

**[d] Power**

For power access located at base level, use a Powerkit base-to-frame jumper cable to connect a spine base receptacle with a fin base receptacle.

**[d] Voice/Data**

To route lay-in cable to an off-module fin wall, installers must field cut the spine wall track.

Be sure the base and desk-height cavity covers match the power system and frame.

TIP

When it comes to cabling, you want two things: capacity and convenience. The lay-in cabling feature available with Montage frames gives you more of both.

### Extra Capacity

Lay-in tracks hold 50 category 5 cables (in addition to the 170+ capacity available in every 20" frame section), making them an excellent choice for technically demanding applications.

### Simple and Convenient

Lay-in tracks can be placed over X, T, L and I junctions, off-module connections, and change-of-height situations. Cables are easily run within tracks installed in place of a top cap, making it unnecessary to install cabling horizontally within the frame. Additional cables can be added or rerouted quickly minimizing occupant disruption.

### Cable Termination

Cabling easily drops from the lay-in track into the frame for voice/data termination.

### Off-Module Fin Routing

To route lay-in cable to an off-module fin wall, installers must field cut the spine wall track.

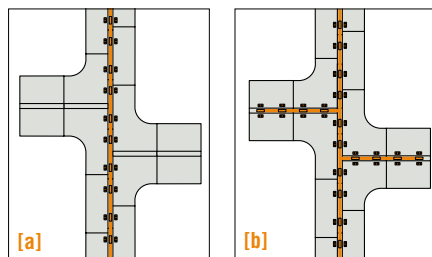

### [a] Spine Only

For easiest installation and reconfiguration, use lay-in tracks only on spine walls.

### [b] Both Spine and Fin

For greatest user access, use lay-in tracks on both spine and fin walls, either on- or off-module.

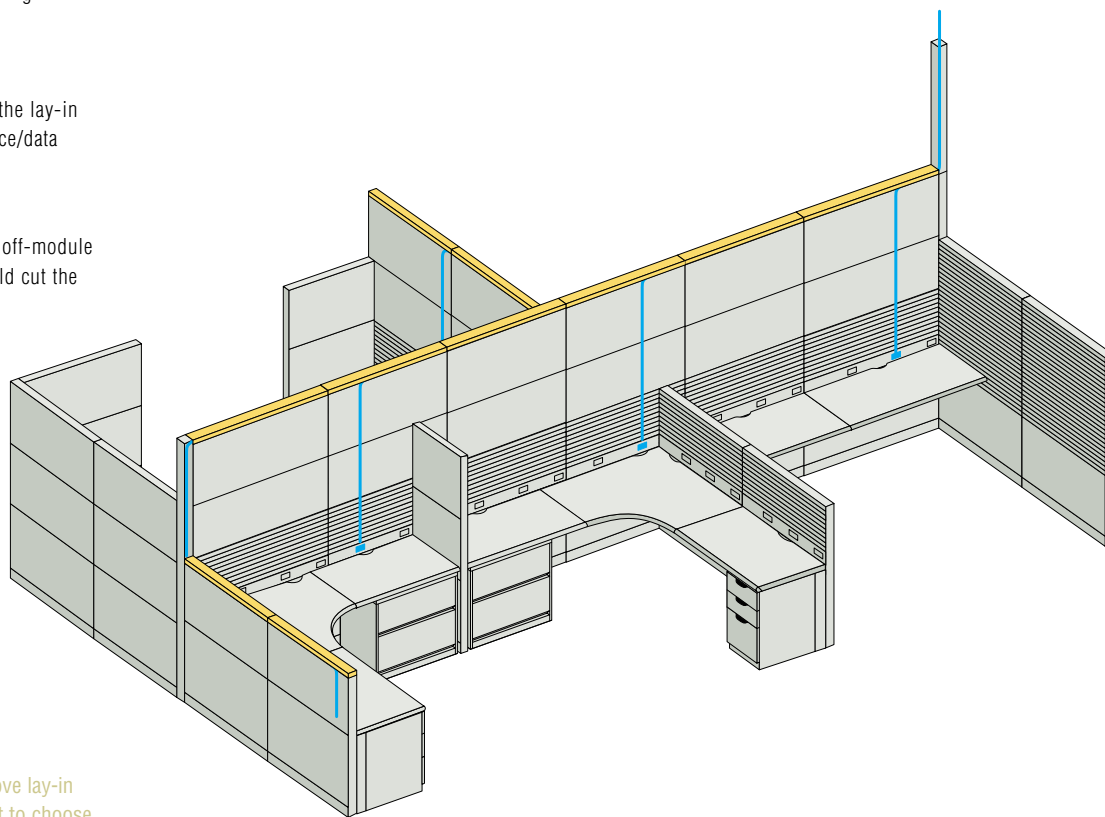

### TIP

Stackers can't be used above lay-in tracks, making it important to choose frame heights carefully.

Square junction covers must be specified for all lay-in applications.

When finishing a frame at the end of a lay-in cable run, be sure to specify the appropriate end-of-run trim. It should be high enough to cover both the frame and the lay-in track (which sits higher than a standard top cap).

Also remember to specify change-of-height trim to cover the exposed portion of the taller frame.

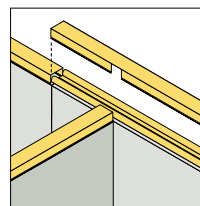

Lay-in top cap with field cut-away for off-module

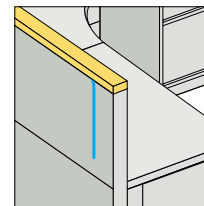

Note the height increase with addition of top cap





*What's your style? Montage tiles can capture it — beautifully. Tiles are interchangeable, so achieving a different look is as simple as moving them around.*

#### Choose From 14 Styles

Montage standard and enhanced tiles are available in 14 styles, many with multiple variations, making it easy to create the perfect mix of aesthetics, privacy, acoustical performance and functionality.

- Painted steel
- Fabric-covered steel
- Perforated steel  
(four perforation densities)
- Indented steel  
(two pattern densities)
- Domed steel (two pattern densities)
- Galvanized steel  
(six pattern densities)
- Tackable acoustical
- High-performance  
tackable acoustical
- Glass (clear, frosted, rice paper,  
strep negative, pinstripe)
- Wood
- Markerboard
- Laminate
- Slatwall
- Base fiber-in

#### Choosing Wood Tiles

Wood tiles are available in naturals and composites. Consider naturals when tiles will be mounted close to Wood Selections components, which use natural veneers. For economy, consider composites. If you're stacking wood tiles vertically, composites are strongly recommended to ensure a complementary grain pattern and future flexibility.



#### Standard or Enhanced?

Standard tiles only fit standard frames. Enhanced tiles can be used on any Montage frame and should be chosen for all new installations. They have special clips that let installers fine-tune their placement for unprecedented fit and finish.

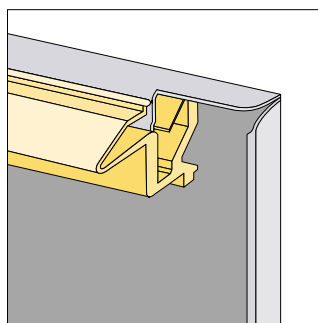

standard tile clip

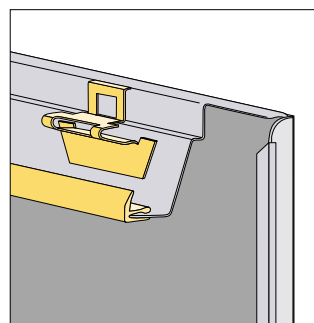

enhanced tile clip

#### TIP

For tile application ideas, see the Montage Tile Portfolio and the Montage CD-ROM.



**When Specifying for the Best Value:**

Use steel or fabric-covered steel tiles where functionality isn't important (e.g., behind bins and under worksurfaces).

Use highly aesthetic tiles such as patterned glass in accent areas.

Use tackable acoustical or high-performance tackable acoustical tiles only where tackability is needed.

Specify two tiles per frame opening for all styles except glass. Each glass package contains two pieces of glass, so one package is sufficient for both sides.

TIP

If you plan to attach components to off-module frames, you may select any type of tile except domed tiles, certain glass tile applications, and tiles covered by fabric thicker than .035 inches. Check the Montage Specification Guide for acceptable fabric thicknesses.

Number of frames ▼	Height of frames 20"   45"   65"   86"   106"				
	▼ Quantity of tiles needed				
1	2	4	6	8	10
2	4	8	12	16	20
3	6	12	18	24	30
4	8	16	24	32	40
5	10	20	30	40	50
6	12	24	36	48	60
7	14	28	42	56	70
8	16	32	48	64	80
9	18	36	54	72	90
10	20	40	60	80	100
20	40	80	120	160	200
30	60	120	180	240	300
40	80	160	240	320	400
50	100	200	300	400	500
60	120	240	360	480	600
70	140	280	420	560	700
80	160	320	480	640	800
90	180	360	540	720	900
100	200	400	600	800	1000

**Tile Calculator**

Draw an elevation view of both sides of each frame run and use the calculator at left to determine the correct number of tiles to specify.

Note: Does not account for cavity covers.



*Need room to spread out? Laminate and wood worksurfaces in a variety of shapes help individuals and teams work at their best.*

### Worksurfaces

Montage, Montage Wood Selections and Answer worksurfaces can all be used with Montage frames and supports to achieve different aesthetics, function and different price points.

### Adjustable Worksurfaces

If you want adjustable-height worksurfaces, you have three options:

Use adjustable cantilevers to support frame-mounted worksurfaces. They allow worksurface height to be adjusted between 24" and 34". [a]

Use freestanding worksurfaces that are adjusted by crank or electrically. They offer a greater range of heights from 26" to 40". [b]

Use panel supported worksurfaces with adjustable keyboard shelves. The keyboard surface adjusts 5" higher or lower than the worksurface height. [c]

### Hanging Worksurfaces Off-Module

When placing worksurfaces off-module, standard on-module supports must be used in combination with off-module worksurface brackets to provide adequate stability. Off-module brackets alone are not sufficient.

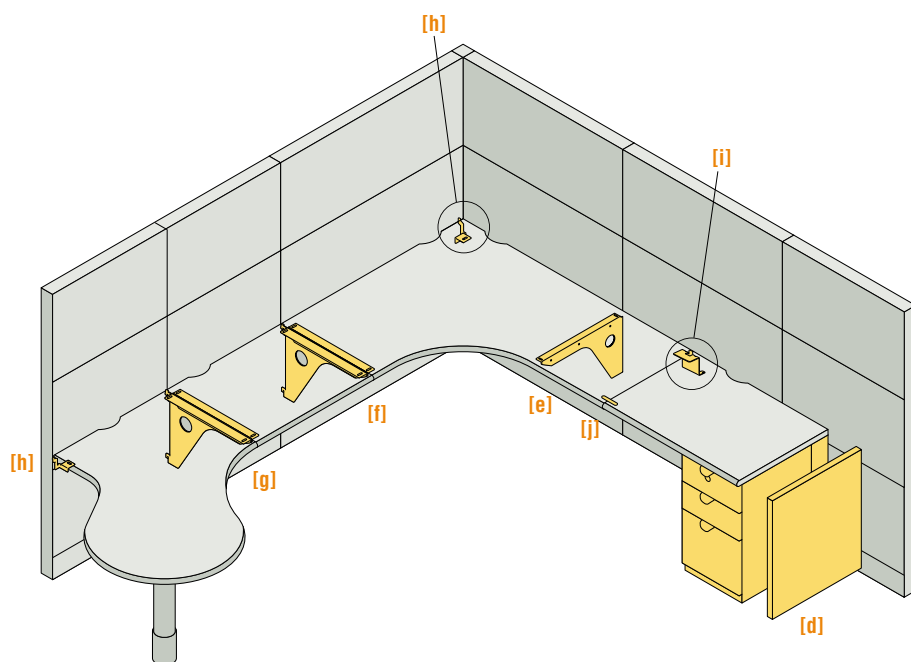
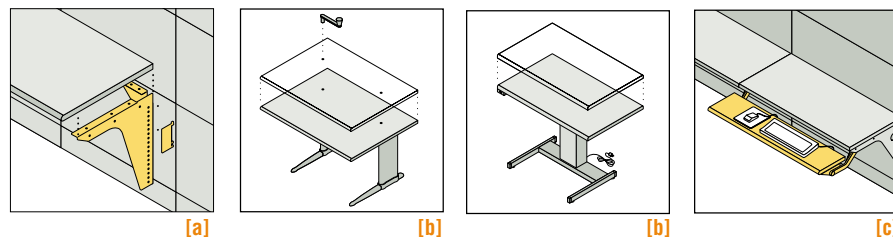

#### TIP

End-of-run cantilevers for corner worksurfaces are available with a more finished look.

Specify all worksurface supports (e.g., brackets, end panels, cantilevers and columns) separately.

Off-module worksurfaces ending more than 6" beyond an on-module support needs an off-module end panel, pedestal or freestanding leg. Those ending less than 6" beyond a cantilever or floor support don't need additional support.

See the Montage Specification Guide for more information on supporting worksurfaces and to determine the appropriate bracket package for each type of connection.

### Supporting worksurfaces

- To support a worksurface you may use an on- or off-module pedestal, on- or off-module end panel or end support bracket. [d]
- Use a cantilever at wall joint. [e]
- Use two cantilevers where straight and corner worksurfaces meet. [f]
- When a straight worksurface meets another surface with its own support column (e.g., visitor and jetty worksurfaces), use a shared cantilever. [g]
- Use end support brackets on the back corner of corner worksurfaces, as well as any other surface wrapped by frames on two sides. [h]
- When worksurfaces meet at a location other than a panel seam, use an off-module bracket to attach the worksurfaces to off-module slots in the frame. [i]
- Use an off-module tie plate [j] to join the front of adjacent worksurfaces in off-module positions. If positioning a pedestal off-module, be aware that the off-module worksurface bracket and tie plate may interfere with the Montage pedestal. To avoid this problem, either shift the Montage pedestal over 1" or use a Context® pedestal instead.

Customize individual workstations with lighting that establishes the proper atmosphere and accessories that help organize work and supplies.

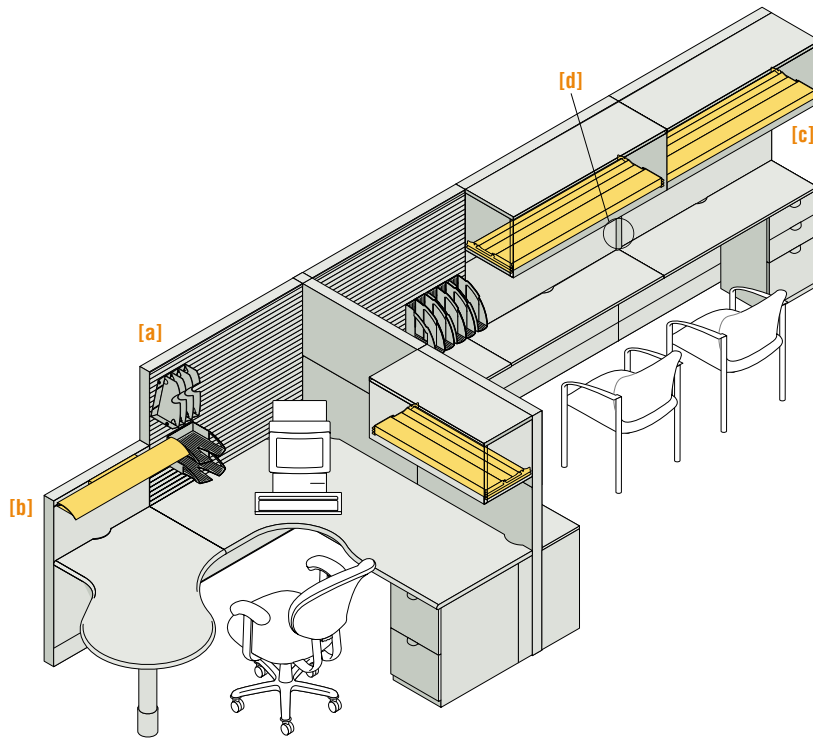

#### Final Touches ...

Montage standard accessories include an art hook to hang pictures and plastic dividers for overhead storage.

#### ...and Attractive Details [a]

Use Details Worktools on Montage slatwall tiles to keep supplies and paperwork close at hand without cluttering the worksurface.

#### Canopy Lights [b]

Canopy lights provide broad coverage and minimize glare. They can be mounted on worksurfaces, frames or tiles.

#### Shelf Lights [c]

Shelf lights mount into the recessed bottom of upper storage shelves and bins. To free up receptacles within a workstation, you can daisy-chain shelf lights together. Check to be sure this is allowed by local electrical codes.

#### Wire Management [d]

For a clean look, use vertical wire managers to conceal shelf light cords.



When attaching a Canopy light to a worksurface, be sure to allow sufficient clearance below and behind the worksurface for the clamp. See the Montage Specification Guide for details.

TIP

*Put everything in its place with Montage storage options. Choose from an extensive variety of components to support your needs for active, anticipated and archived storage.*

### Metal

Standard Montage storage components are made of metal and include several lengths of overhead shelves and bins, as well as pedestals in two depths. Overhead storage hangs on frames. Pedestals can support worksurfaces or stand alone as mobile pedestals. Choose from two pull styles: rod or waterfall. Metal bins and pedestals with wood fronts are also available.

### Wood

Montage also offers an array of storage options crafted of wood veneer, including overhead shelves and bins, mobile pedestals, vertical cabinets and bookcases. Seven pull styles and multiple finish options let you create the perfect look, from traditional to contemporary.

### Mix and Match

For greater variety, combine Context, Answer, Avenir or Turnstone® storage pieces with Montage. All complement Montage beautifully.

### Hanging Upper Storage Off-Module

With the enhanced off-module frame, you can hang Montage bins, shelves, and Wood Selections overhead storage cabinets off-module. The exception is bins longer than 48".

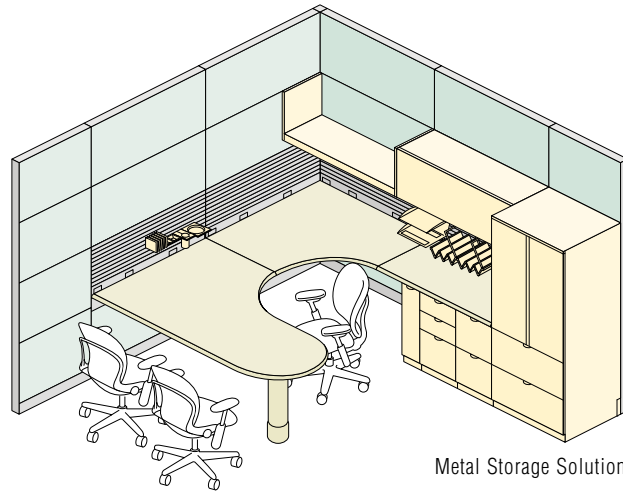

Metal Storage Solutions

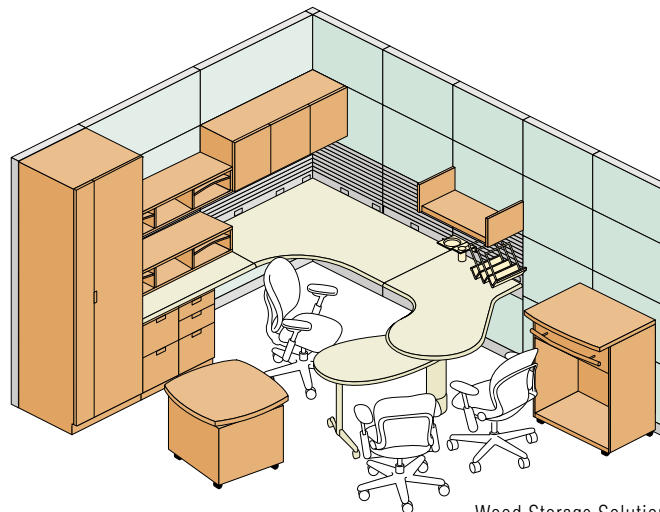

Wood Storage Solutions

#### TIP

#### Off-Module Planning Tips

If mixing on-module and off-module upper storage, consider using off-module brackets for all pieces. The off-module bracket pushes the bin out from the panel 5/8". By using it on all bins, you'll maintain a level plane.

To mount an off-module bin directly over a 45" fin wall, the top cap must be modified in the field.

An off-module bin bracket cannot span a vertical frame rail.

#### General Planning Tips

100/200 Series pedestals, Answer pedestals and Answer low-cost pedestals work with Montage. Check the Specification Guides for these products to determine dimensional compatibility with your application.









Steelcase®